

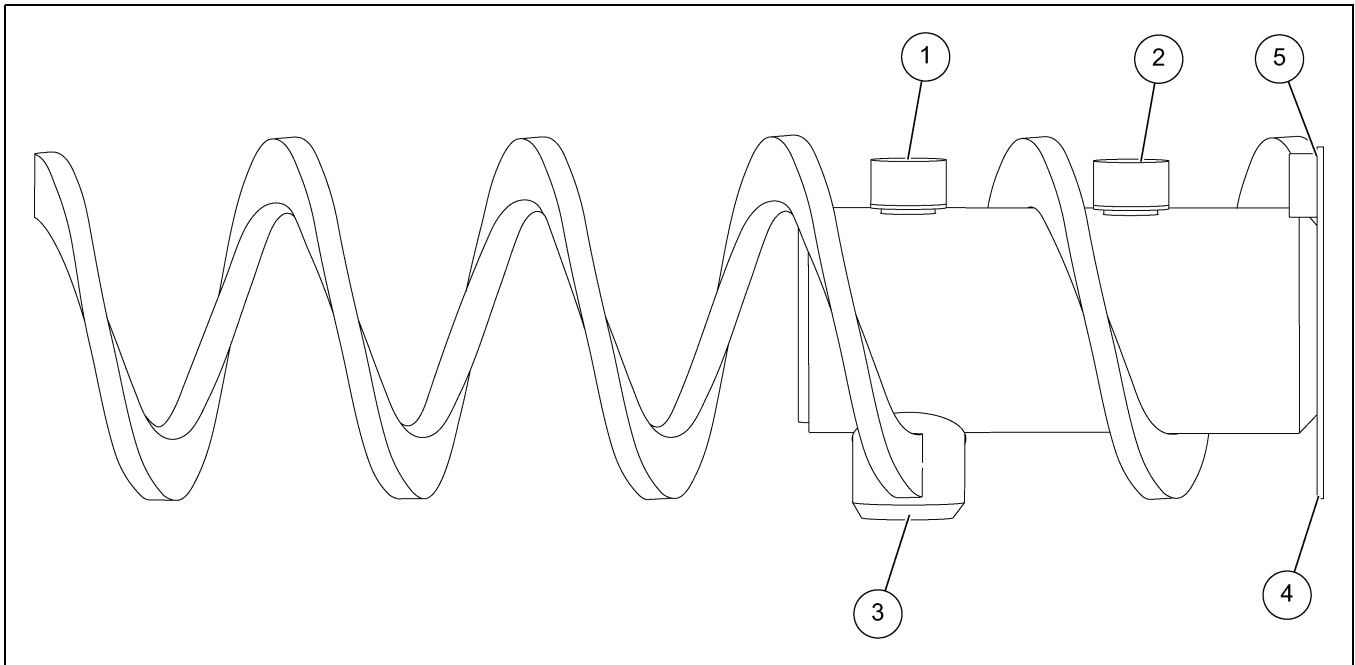

1004 East Illinois Street • Assumption, IL 62510 • 1-217-226-4421

Instructions Flex-Flo Model 300 and Model 350 Auger Driver Hardware Sheet



Ref #	Description
1	Auger Lock Bolt (Torque to 20 ft.-lbs.) (Refer to below table.)
2	Bolt, SHCS 5/16"-18 x 1-1/2" (S-6481) (Torque to 20 ft.-lbs.)
3	Auger Lock
4	Welded Washer
5	End of auger must make contact with welded washer.

Auger Lock Bolt Part Numbers (1)		
Models	Part #	Description
Model 300	S-6481	Bolt, SHCS 5/16"-18 x 1-1/2" Type B Cup Point
Model 350	S-8660	Bolt, SHCS 5/16"-18 x 1-1/4" Cup Point

Date: 04-03-18 V1.0

Printed in the U.S.A.
Copyright © 2018 by The GSI Group, LLC
www.gsiag.com



PNEG-2225

Page 1 of 1
CN-335068